

Maintenance and Care

This product is finished to a high standard. For cleaning, please use a damp cloth.

No abrasive cleaning materials should be used. Any misuse will invalidate your guarantee.

Troubleshooting

Fault: Hot is coming out when I select cold or vice versa:

Cause: Hot and cold pipes are connected the wrong way around.

Fault: Fluctuating flow rate:

Cause: Possible blockage in the system or operating conditions is incorrect.

Fault: Low or no flow from the valve:

Cause: Possible blockage in the system, operating conditions is incorrect or there is a blockage in the system.

Fault: Leak from the valve:

Cause: The holder isn't inserted to the bottom.

The logo for LUSO, consisting of the word "LUSO" in a bold, white, sans-serif font, centered within a solid black rectangular background.

LUSO Hygiene Douch Kit (302/HA30 SET)

Installation & Maintenance Guide

Important Information

This product has been fully tested prior to it leaving the factory. In some cases you may find water residue on the parts.

To ensure you get the best use from this product, please read this installation guide thoroughly.

This product has been designed for wall mounting. The product is suitable for use on all boiler systems including pumped, gravity and combination boilers to a maximum pressure of 5 bar. Pressure above this may require the fitting of reducer valves.

We recommend that a fully qualified plumber install this product.

If you experience any difficulty with the installation or operation of this system, please refer to the Troubleshooting guide.

Product Contents

1. Valve X 1
2. Protective cover X 1
3. Douche holder X 1
4. Douche X 1
5. Hose X 1

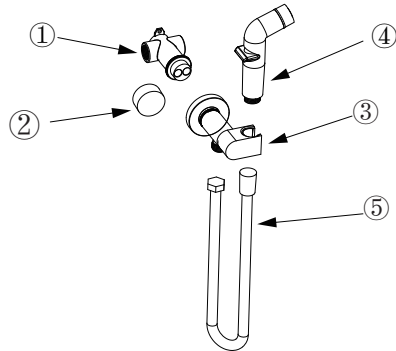

Installation

Before installation, please make sure your system is suitable. Mark the position of the valve and fix it in place using the screws provided. Connect the hot and cold water feeds. Attention: As shown in figure 2-1, the buried depth of the valve in wall is 65mm. Take off the plastic cover after the tiling. Carefully install the holder to the valve and screw it tight. Check leakage. Now install the hose and douche tightly and check leakage.

