

LUSSO

S T O N E

Concealed Shower System

Installation & Troubleshooting Guide

Important Information

PLEASE MAKE SURE YOU FULLY TEST YOUR PRODUCT BEFORE TILING ETC. WE WILL NOT BE RESPONSIBLE FOR ANY COSTS INVOLVED IN REMOVAL OF THE SHOWER IF YOU FIND THERE IS A FAULT.

Please make sure you thoroughly flush your existing pipe work before connecting up to the valve. Failure to do this can result in debris getting into the cartridges, which can result in poor performance and a buzzing noise coming from the valve.

We recommend that a fully qualified plumber install this product.

This product has been fully tested prior to it leaving the factory. In some cases you may find water residue on the valve or parts.

To ensure you get the best use from this product, please read this installation guide thoroughly.

This product has been designed for concealed wall installations. The product is suitable for use on all boiler systems including pumped, gravity and combination boilers to a maximum pressure of 5 bar. Pressure above this may require the fitting of reducer valves.

If you experience any difficulty with the installation or operation of this system, please refer to the Troubleshooting guide.

Valve contents

Please note: Parts may vary in design depending on the model supplied

No.	Name	Quantity
1	Shower Valve	1
2	Back Plate	1
3	Lever Positioning Ring	1
4	Thermostatic Handle	1
5	Grub Screw	2
6	Lever Hole Cover	2
7	Diverter Handle	1
8	Screw	2
9	Plug	2
10	Allen Key	1

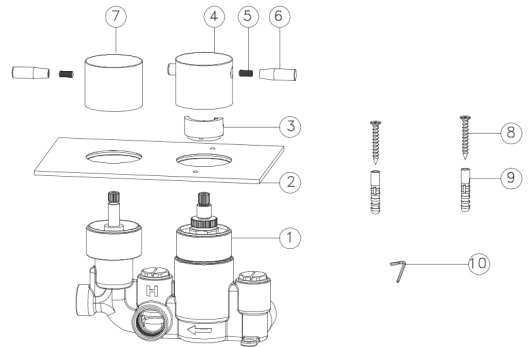

Installation

Before installation, please make sure your system is suitable.

Remove the Chrome/black/stainless/Rose Gold sleeves from the shower valve and put to one side.

Install accessible isolation valves in the hot & cold pipelines for servicing purposes.

Plumbing connections on the inlets are $\frac{3}{4}$ " BSP female threads. Plumbing connections on the outlets are $\frac{1}{2}$ " BSP female threads.

Make a recess in the wall to house the valve. The recess needs to be between 72-85mm deep.

Using the screws provided, secure the valve onto the wall, using the mounting lugs. It is very important that there is no movement on the valve once secured.

Now the valve is installed, make sure the pipework is thoroughly flushed to remove any debris from the system before connecting the water supply. **Failure to do this could invalidate the guarantee.**

Now connect the hot & cold water to the correct inlets. It is very important that you connect the correct feeds into the correct inlets.

Make the plumbing connections to the outlets.

Turn on the water supply and check for leaks.

Refit the sleeves onto the shower valve

Carefully slide the back plate over the sleeves to avoid scratching them.

Make sure the Temperature spindle is in the correct position (there is a marker on the spindle and cartridge, these must be lined up)

Now install the black plastic lever-positioning ring. Failure to put this in the correct position will result in temperature issues such as boiling hot or cold water. The valve will fail to mix.

Now install the Handles by sliding them over the rods and tightening with the Allen key supplied.

Now install the outlet parts.

Maintenance and Care

This product is finished to a high standard. For cleaning, please use a damp cloth. No abrasive cleaning materials should be used. Any misuse will invalidate your guarantee.

Troubleshooting

Fault: Shower only runs hot or cold water

Cause: Hot and cold water supplies are plumbed to the wrong sides of the valve. Lever positioning ring is not installed or not set correctly.

Fault: Leak from the valve in the off position

Cause: Debris has got into the diverter valve

Fault: Fluctuating Flow Rate:

Cause: Possible blockage in the system or operating conditions is incorrect

Fault: Low or no flow from the valve

Cause: Possible blockage in the system, operating conditions is incorrect or there is a blockage in the system.

Fault: Vibrating/buzzing noise coming from the valve

Cause: Water pressure is over 5 bar or under 0.5 bar or debris has got into the valve due to none flushing or existing pipe work prior to connecting to the valve.

Customer care: 0203 370 4057 (International +44 203 370 4057)