

Top View - Section View

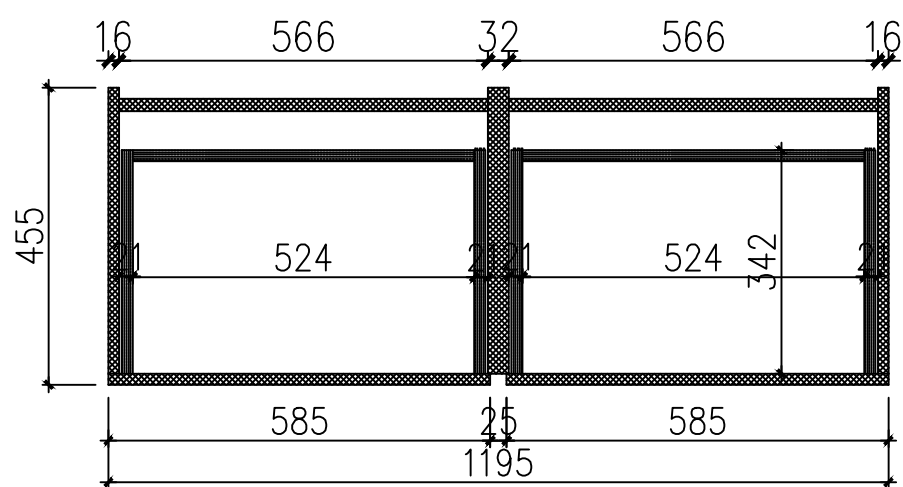

Side View - Section View

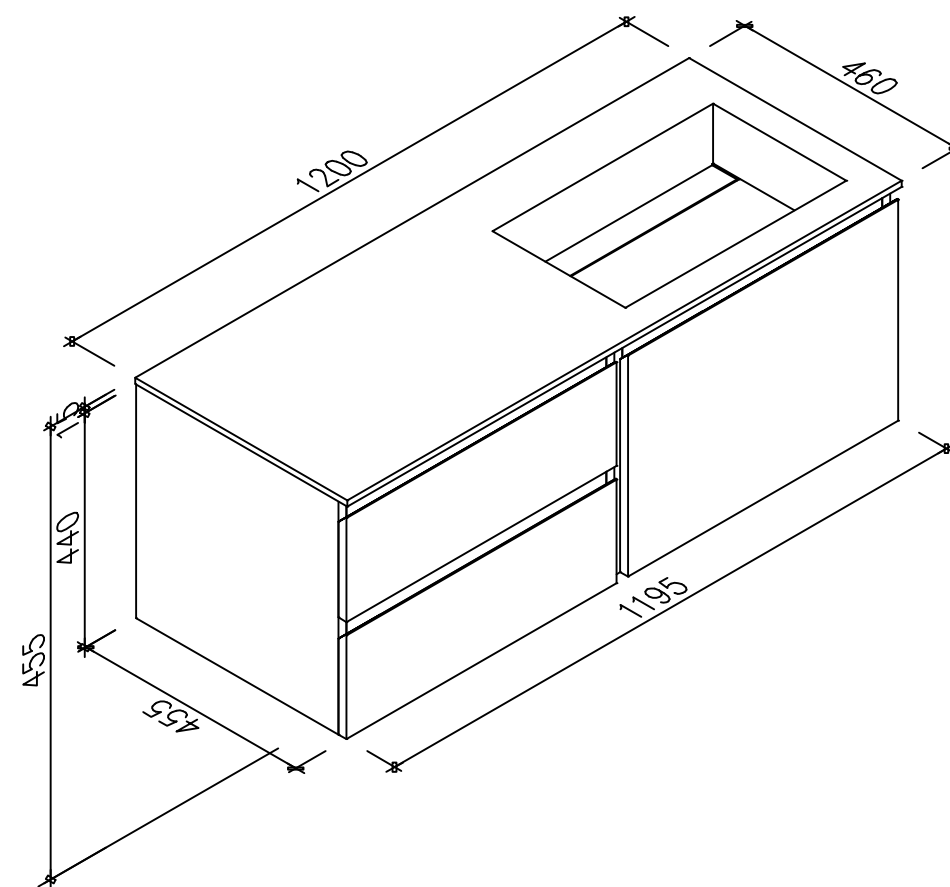
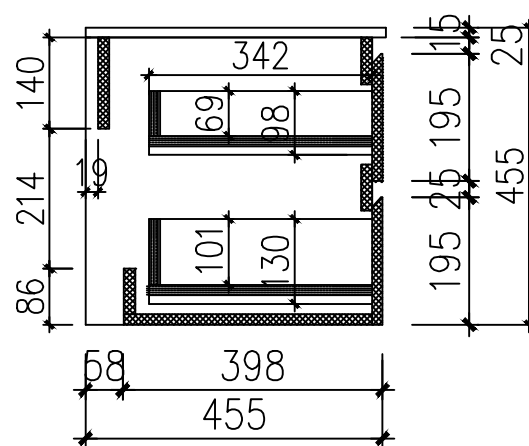

LUSO

Product Name	Vola Vanity Unit 1200
Material	Stone Resin & Wood
Size, mm	1200 x 455 x 455

All dimensions provided in millimeters.
All vanity units are supplied with no tap hole (s). If you require a tap hole, you will need to use a standard 38mm hole-saw drill attachment.